

ALUMINUM CLAD SLIDING PATIO DOOR

door types

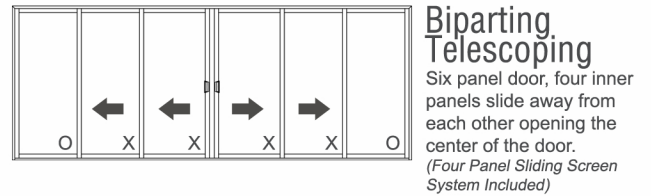
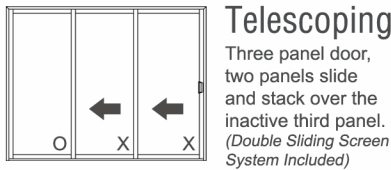
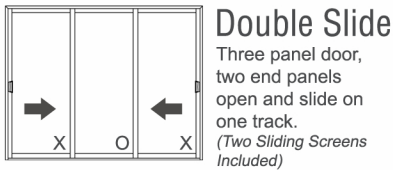
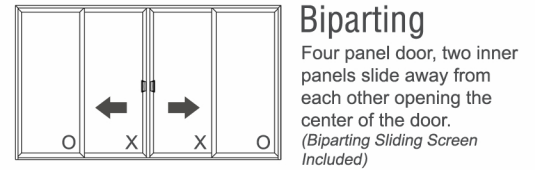
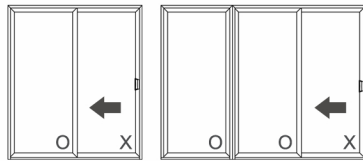
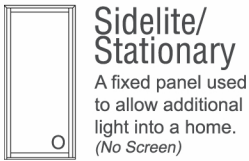

custom sizes & combinations

Patio doors are available in any size within a 1/16" of an inch between our minimum and maximum dimensions. Additionally, patio door units can be mullioned with other doors, transoms, or stationary panels to fill an opening or allow more light into a home.

handing

Handings are noted with "X" being an active panel and "O" as a stationary panel. Single slide doors can be modified to be handed many different ways including sliding from left to right, or from right to left. Additionally the active panel can be in the middle of a three panel door.

panel options

Sliding patio doors can have 2-1/2" or 4-1/2" wide rails which make up the sides and top and bottom of the stationary and moving panels.

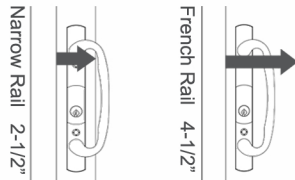

standard size widths

Select from the different widths and door types show below.

Casco Callout	Width	Type	Unit Dimension - Width	Egress
CSLS26XX	2/6	Sidelite	2' 7-5/8" (31-5/8")	N/A
CSLS30XX	3/0	Sidelite	3' 1-5/8" (37-5/8")	N/A
CSLS40XX	4/0	Sidelite	4' 1-5/8" (49-5/8")	N/A
CSL50XX	5/0	Single Slide	4' 10-7/8" (58-7/8")	22-15/16"
CSL60XX	6/0	Single Slide	5' 10-7/8" (70-7/8")	28-15/16"
CSL80XX	8/0	Single Slide	7' 10-7/8" (94-7/8")	40-15/16"
CSL76XX	7/6	Single or Double Slide	7' 6-1/2" (90-1/2")	22-15/16"
CSL90XX	9/0	Single or Double Slide	9' 0-1/2" (108-1/2")	28-15/16"
CSL120XX	12/0	Single or Double Slide	12' 0-1/2" (144-1/2")	40-15/16"
CSLB104XX	10/4	Biparting	9' 8-15/16" (116-15/16")	40-5/16"
CSLB124XX	12/4	Biparting	11' 8-15/16" (140-15/16")	58-5/16"
CSLB164XX	16/4	Biparting	15' 8-15/16" (188-15/16")	82-5/16"
CSLT76XX	7/6	Telescoping	7' 2-5/16" (86-5/16")	49-1/16"
CSLT90XX	9/0	Telescoping	8' 8-5/16" (104-5/16")	63-1/16"
CSLT120XX	12/0	Telescoping	11' 8-5/16" (140-5/16")	86-1/16"
CSLBT150XX	15/0	Biparting Telescoping	14' 3-11/16" (171-11/16")	100-3/8"
CSLBT180XX	18/0	Biparting Telescoping	17' 3-11/16" (207-11/16")	124-3/8"
CSLBT240XX	24/0	Biparting Telescoping	23' 3-11/16" (279-11/16")	172-3/8"

Replace the "XX" in each callout number with the required callout height numbers.
French rail option callout changes to "CFSL"

GRILLE DESIGN STYLES

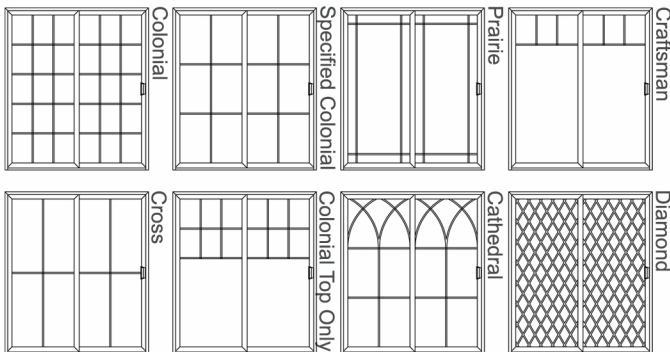

light opening

Two Panel w/Narrow Rail:
Unit Width - 8.88" = Light Width
Unit Height - 7.06" = Light Height

Two Panel w/French Rail:
Unit Width - 17.13" = Light Width
Unit Height - 11.32" = Light Height

measurement guide

A reference guide on how to measure for new patio doors is available on Casco's website:
www.cascoonline.com/measure

standard size heights

6/9 RO Height

Unit Dimension Height:
6' 8-1/16" (80-1/16")

Call Out Height: (69)

6/11 RO Height

Unit Dimension Height:
6' 10-1/16" (82-1/16")

Call Out Height: (611)

8/0 RO Height

Unit Dimension Height:
7' 11-1/16" (95-1/16")

Call Out Height: (80)

unit numbers



rough opening

Rough Opening Width: Add 5/8" to Unit Dimension Width
Rough Opening Height: Add 13/16" to Unit Dimension Height