



Casco Aluminum Clad Double Hung

Standard and Optional Features

Standard Features:

- Heavy-gauge extruded aluminum cladding (0.050") for exceptional durability and enhanced exterior appeal
- Maximum exposure of wood (pine) on the interior for a classic aesthetic
- Elegant rail-routed finger lifts
- Double-screwed frame corners and corner seals for superior air and weather protection
- Painted exterior finish with AAMA 2604 performance
 - Eight exterior Standard Colors for selection
- Exterior mounted extruded aluminum screen frame with stabilizer bar, easy in-and-out spring design, and standard fiberglass screen mesh featuring Microban
- Solid wood sash and frame component construction
 - All wood includes Woodlife 111 treatment providing moisture and decay protection, helping to prevent warping, swelling, and fungal damage while maintaining compatibility with paint and stain finishes
- Interior glazed sashes for enhanced water protection, security, and prolonged product life
- 3/4" clear Cardinal Insulating Glass unit with a 20-year seal failure warranty
- Low-profile sash lock, concealed from the exterior for a clean look and enhanced security
- Tilt-in top and bottom sashes (tilt latch) for effortless cleaning
- Beige step jamb liner with overlapping different-sized sashes
 - Featuring matching sightlines, the step jamb liner improves weather resistance while allowing the sashes to tilt in for easy cleaning. The step jamb design also eliminates the hassle of aligning hardware with tracks, ensuring smooth operation and effortless re-closing after cleaning/maintenance
 - While returning sashes to operating position after cleaning, the step jamb liner does not allow the sashes to go past vertical making operation user friendly
- Interlocking check rail for added security, wind/water penetration resistance, and locking stability
- Triple sill weather-stripping with a unique bulb and fin design for ultimate air and water performance
- Coppertone interior hardware
- Hard vinyl fold-down & removable nailing fins with integrated head drip cap to direct water and ice away

Optional Features:

- Custom sizes between the smallest and largest standard sizes to meet specifications to 1/16"
- Painted exterior finish with AAMA 2604 performance
 - 22 designer Estate Color options
 - Custom exterior clad color options available
- Additional hardware colors (lock, keeper, tilt latches) in white, beige, or matte black
- BetterVue and PetScreen fiberglass screen mesh
- Cardinal IG's full line up of LoE soft and hard coat products for enhanced energy efficiency
- Obscure, tinted, or tempered glass for added privacy and safety
- Factory-installed pine wood extension jambs - factory applied up to 8-1/4"
- Grille options:
 - 5/8" & 13/16" flat grilles, available in single-color or two-tone between the glass
 - 3/4" & 1" contour/profile grilles, also available in single-color or two-tone between the glass
 - 7/8" and 1-1/4" Simulated Divided Light (SDL) grilles, with optional between-the-glass grilles
 - Removable wood interior grilles with full surround or no surround
- Pre-finished interiors in primed only, painted (white/black), or stained factory finish (11 standard stain colors)
- Exterior aluminum accessory surrounds
 - 1-3/4" aluminum colonial brick molding for a traditional aesthetic (with or without nail fin)
 - 1-7/8" or 4" modern flat aluminum surround material with score lines for adjusting
- High-quality factory mulling for seamless window combinations, delivering a polished and professional finish
- Available field mull options as well as extruded aluminum spread mull covers for both 2" and 3-1/2" versions

Additional information can be found at www.casconline.com or by calling 800-806-6333 and speaking to a customer service representative.

Technical Drawing Double Hung

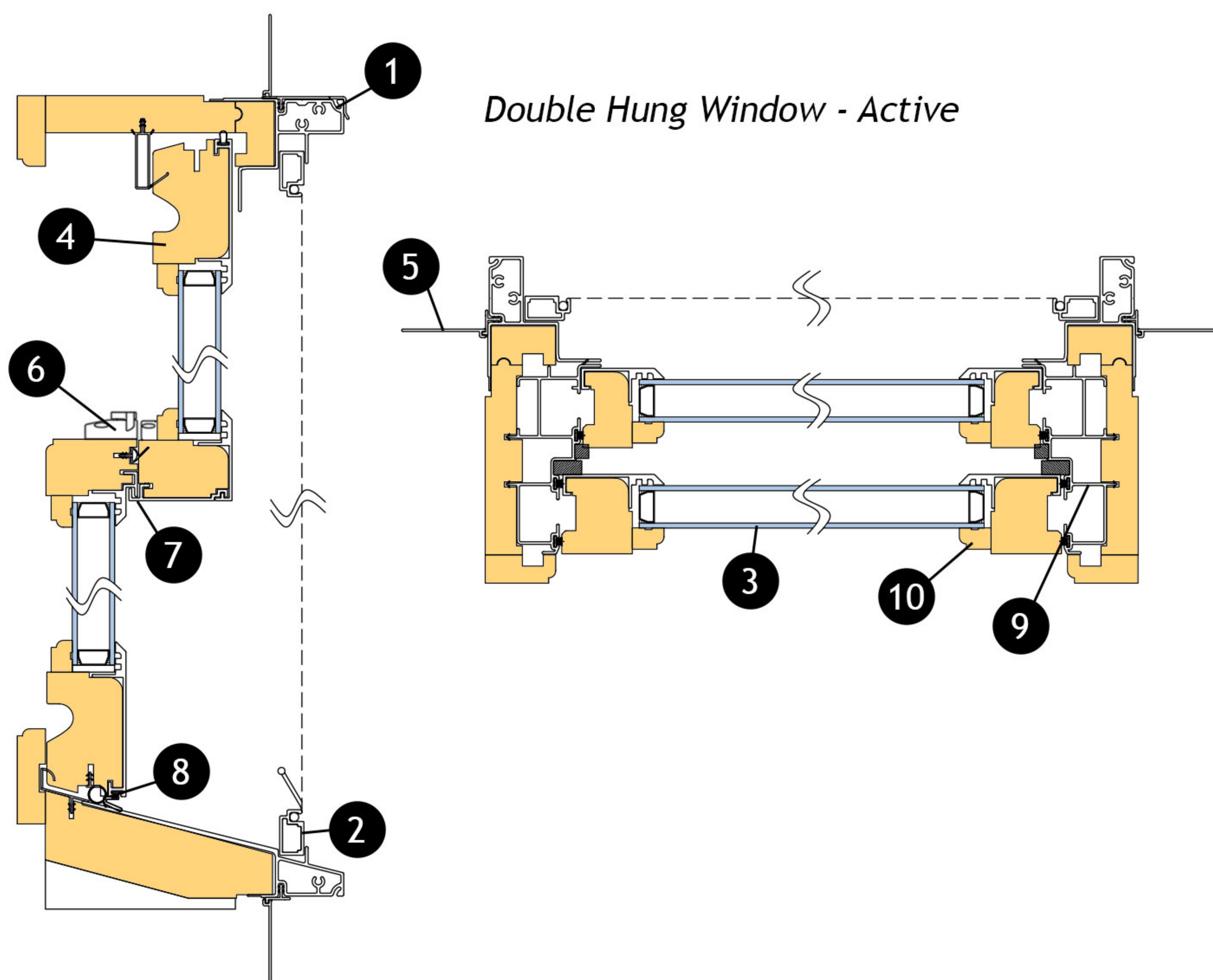

1. Fully extruded aluminum sash and frame cladding for unmatched durability and a sleek exterior finish.
2. Robust fully extruded aluminum screen frame ensures lasting strength and seamless integration.
3. Cardinal 3/4" insulated glass with warm edge technology maximizes energy efficiency and comfort.
4. Elegant wood interior prepped for finishing adds timeless beauty and customization options.
5. Fold-down, removable vinyl nail fin with corner pads ensures easy installation and secure fit.
6. Low-profile sash lock hidden from exterior view for a sleek, secure look.
7. Integrated extruded aluminum sash interlock enhances structural integrity and weather resistance.
8. Top-of-the-line weather-stripping provides ultimate protection from drafts and moisture.
9. Streamlined step jamb liner ensures smooth operation and a refined appearance.
10. Externally glazed glass adds superior durability and enhanced security for long-lasting performance.

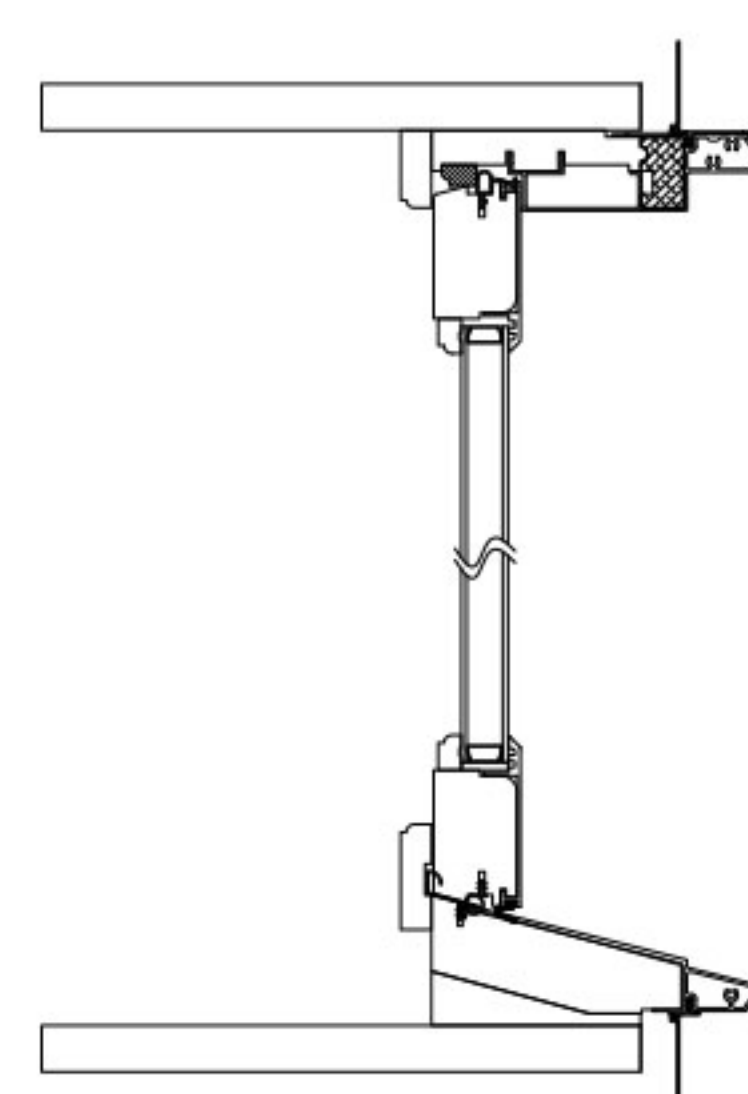
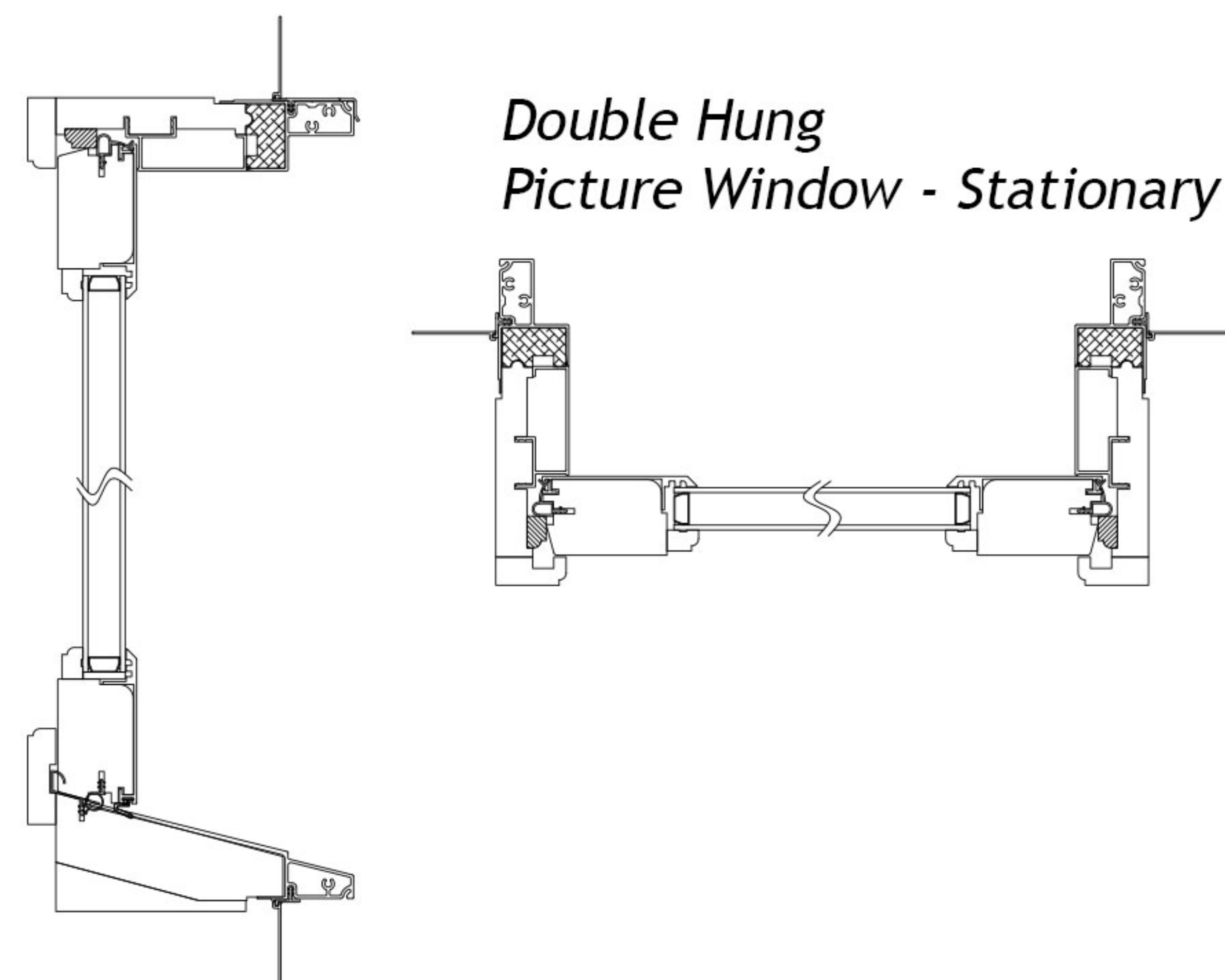

Double Hung Combination - 30° Bay Window

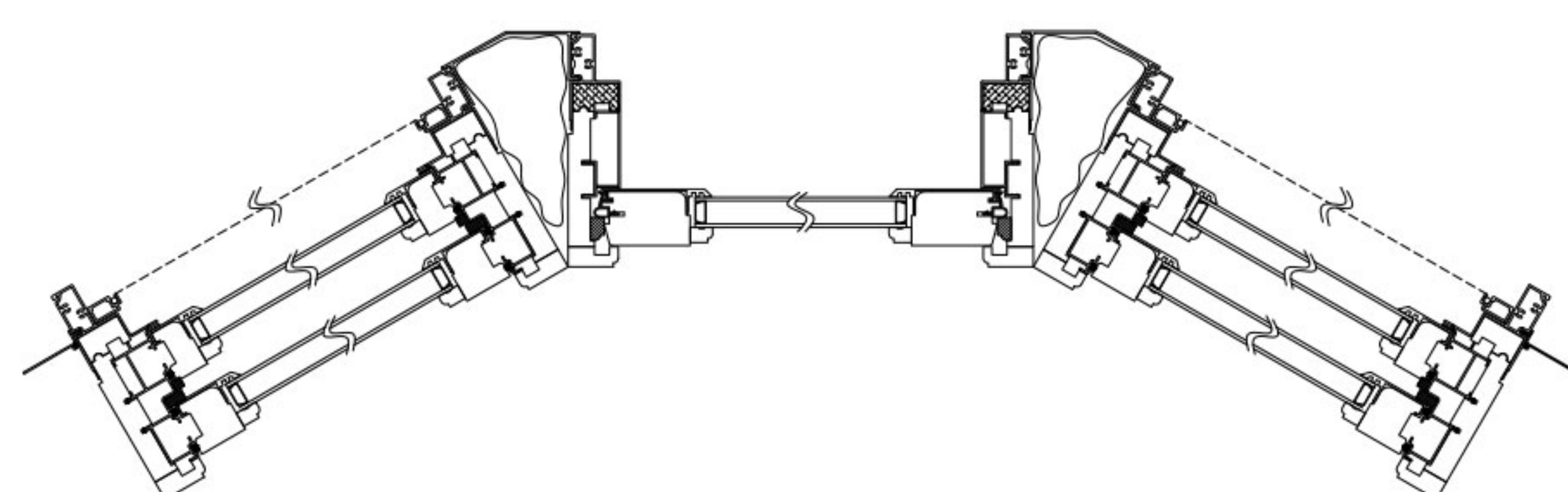

Double Hung Combination - 45° Bay Window

Casco Double Hung Window

- Product Performance and Testing
 - AAMA/WDMA/CSA 101/I.S.2/A440-11 & A440-08, NAFS2011
 - Design Pressure - LC40
 - ANSI/NFRC400-2017
 - Air Leakage: ≤ 0.2 cfm/ft²

Casco Double Hung Picture Window

- Product Performance and Testing
 - AAMA/WDMA/CSA 101/I.S.2/A440-11 & A440-08, NAFS2011
 - Design Pressure - LC30
 - ANSI/NFRC400-2020
 - Air Leakage: ≤ 0.2 cfm/ft²

Glass performance ratings can be found on CASCOPRO quotes as well as in the *Resource* section of our web page at www.cascoonline.com.